

## pr1meFX

NEW COVE CONSTRUCTION AND EXISTING COVES  
INTEGRAL POWER SYSTEM



## INSTALLATION INSTRUCTIONS

---

Ratings, Hardware and Warning.....	Page 1
Installation Guidelines.....	Page 2
Installation Instructions.....	Page 3-5

---

### IMPORTANT:

Before installing the pr1me-FX be sure to install Tempo Surge Suppression Device (SSD-120/SSD-277) to every branch circuit to validate warranty.

### ELECTRICAL RATINGS

pr1me-FX Products are High Voltage,  
Operating at 120VAC

### REQUIRED HARDWARE

- 1) Power Feed Cable (PFpFX-F-36) & (PFpFX-M-36)
- 2) Mounting Hardware, screws provided Surface mount (pFX-SM)



PFpFX-F-36

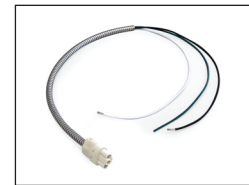

PFpFX-M-36

### HARDWARE PROVIDED BY OTHERS:

- 1) Laser Level
- 2) Power tools
- 3) Hand tools



JFpFX-JF-12



pFX-SM

### OPTIONAL HARDWARE

- 1) Jumper Feed Cable (JFpFX-JF-12)

NOTE: For maximum pr1meFX lengths, please refer to Specification Sheet



### WARNING:

Read and understand these instructions before installing. This product must be installed in accordance with the applicable installation code by a person familiar with the construction and operation of the product and the hazards involved. Turn off main power supply before you start installing pr1meFX.

## pr1meFX

NEW COVE CONSTRUCTION AND EXISTING COVES  
INTEGRAL POWER SYSTEM

### INSTALLATION GUIDELINES

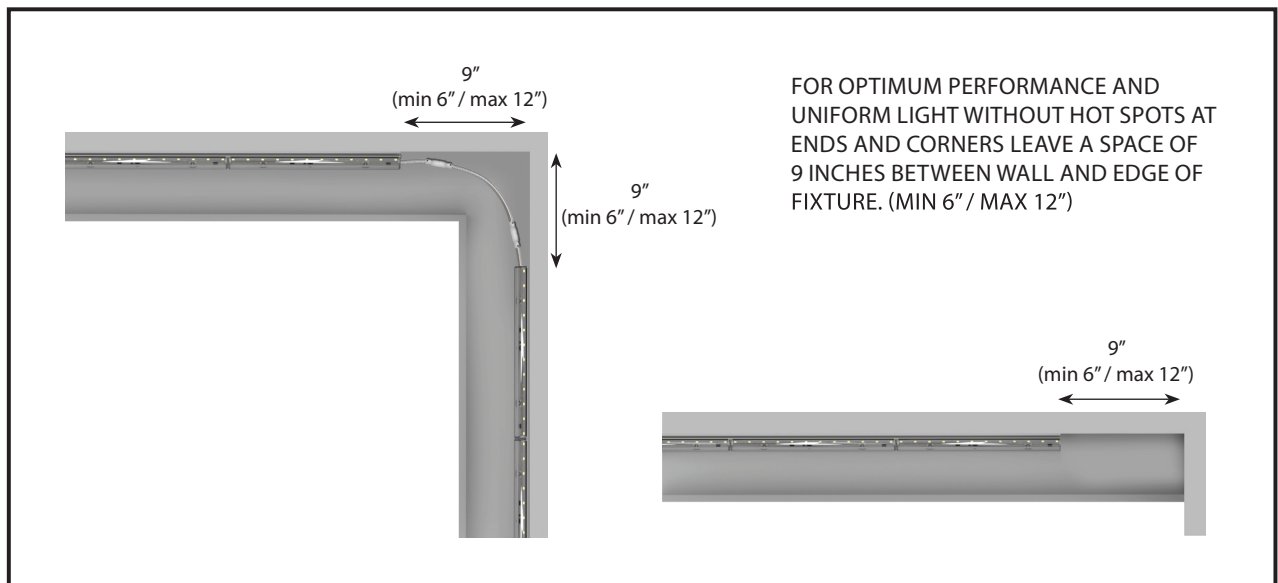
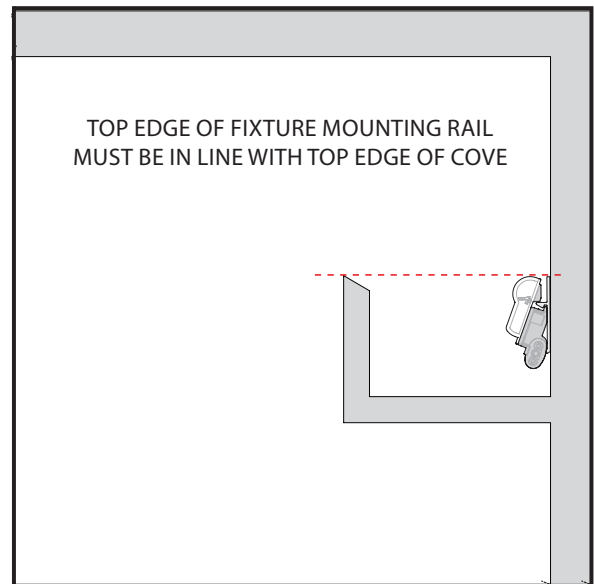
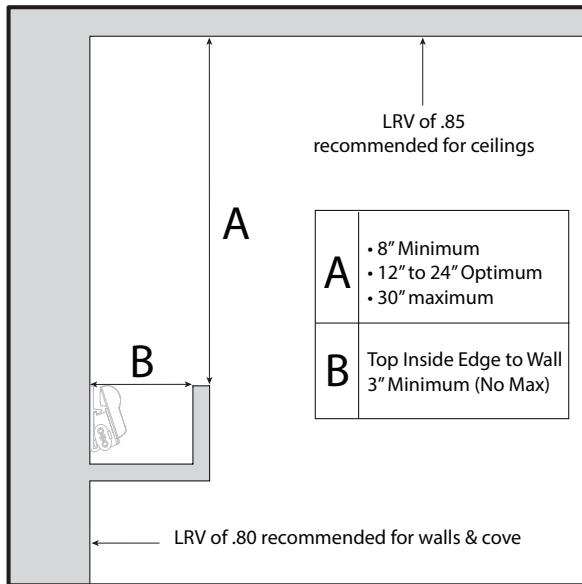

## pr1meFX

NEW COVE CONSTRUCTION AND EXISTING COVES  
INTEGRAL POWER SYSTEM

## INSTALLATION

### IMPORTANT:

To achieve proper fixture ground, supplied Tempo Power Feed Cable (PFC) assembly must be used and attached to grounded J-Box. When connecting field wires to PFC wires observe polarity; I.E. White to neutral, Black to Line and Green to ground.

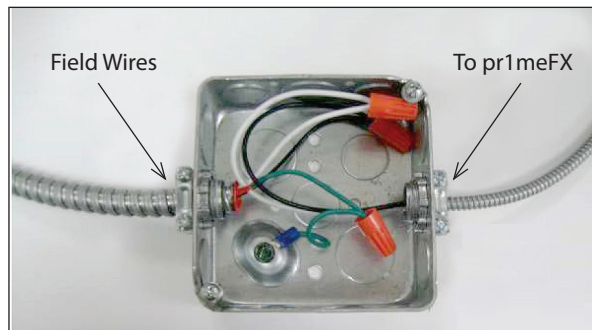

### STEP 1

#### Mounting of pr1meFX track:

Using a laser level, define a reference line for mounting the pr1me-FX track. Place the track on mounting surface according to reference line and secure using appropriate hardware, by tool, until secured as shown in **Figure 1** and **Figure 2**.

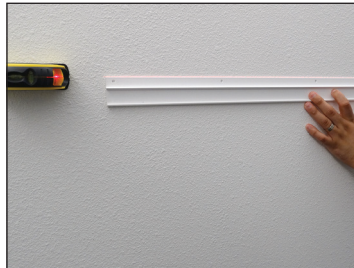

Figure 1



Figure 2

### STEP 1A - DOUBLE FEED IN CENTER OF RUNS

#### Locating Power Feeds:

Determine where the start of runs will be and drill hole for conduit feed in between runs as shown in **Figure 3**. Attach mounting rails to the left and right side of conduit hole, 1" apart as shown in **Figure 4**.



Figure 3



Figure 4

## pr1meFX

NEW COVE CONSTRUCTION AND EXISTING COVES  
INTEGRAL POWER SYSTEM

## INSTALLATION

### STEP 1B - SINGLE FEED AT END OF RUNS

#### Locating Power Feeds:

Drill hole a far left of run, 1" to 3" from end of run. Use Female power feed cable as shown in **Figure 5**. Drill hole a far right of run, 1" to 3" from end of run. Use Male power feed cable as shown in **Figure 6**.

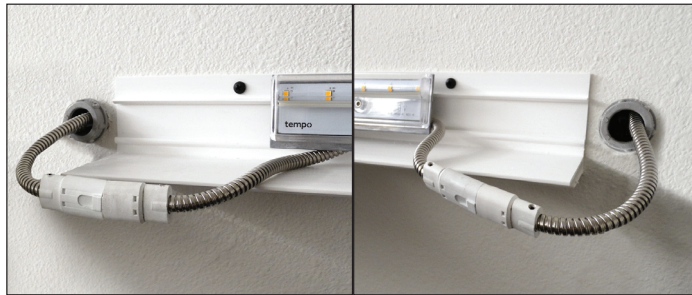

Figure 5

Figure 6



**NOTE:** Hole for conduit can be drilled through the rail as needed.  
Conduit Bushing is optional

### STEP 2

#### Mounting pr1meFX onto track:

Place pr1me-FX on the mounting track by placing the fixture over the mounting track making sure to push the bottom side of the fixture on the clip hook until engaged onto the lip, as shown in **Figure 7**. Once first hook is engaged, carefully push the fixture so that the second clip hook engages to the top of the pr1me-FX fixture, as shown in **Figure 8**.



Figure 7



Figure 8

## pr1meFX

NEW COVE CONSTRUCTION AND EXISTING COVES  
INTEGRAL POWER SYSTEM

### INSTALLATION (continued)

#### STEP 3

##### Connecting power to the pr1meFX:

Connect the female connector on the PFC to the male connector on the Pr1me-FX until clips are engaged, as shown in **Figure 9**.

Note: When connecting female to male connector ensure that the guide is inserted correctly into the guide hole for proper connection. As shown in **Figure A**.



Figure 9

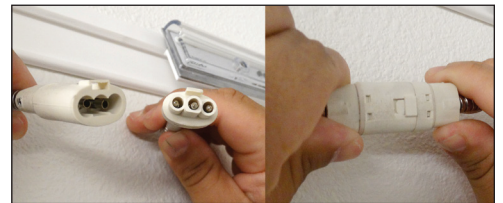

Figure A

##### Connecting fixture to fixture:

The pr1me-FX can be joined to other pr1me-FX products by inserting male connector and terminating to the female connector to the next fixture, as shown in **Figure 10** and **Figure 11**.

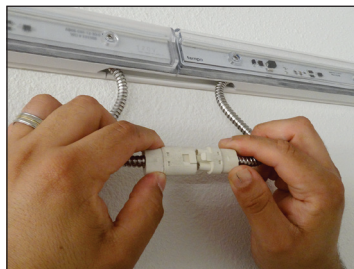

Figure 10



Figure 11

#### STEP 4 (OPTIONAL)

##### Retracting Fixture:

The pr1me-FX fixture can retract up to 1/2" for every 1' module, as shown in **Figure 12** and **Figure 13**, by removing telescoping spacers, grabbing both fixtures and carefully pulling them together. Use this feature to fit the fixture into odd length areas, as shown in **Figure 14**.

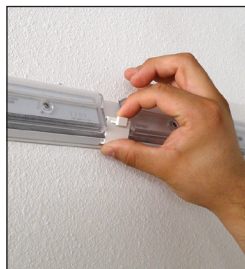

Figure 12

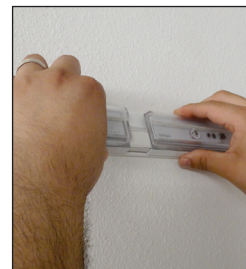

Figure 13

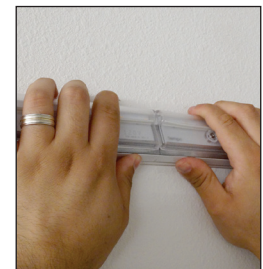

Figure 14